

**DN**



# Dimensions

## Inlet – Provided in inches

Dimensions are for reference only and may change depending on accessories used. For precise dimensions contact MELTRIC Engineering.

### plug

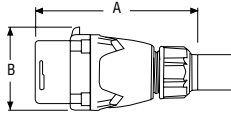

PRODUCT	A	B
DN9c	5.79	3.39
DN20c	10.75	4.92

### inlet with connector inlet

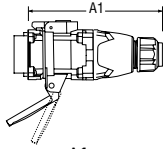

PRODUCT	A1
DN9c	6.85
DN20c	12.24

### inlet

PRODUCT	A	C	E	H	Ød	ØD
DN9c	2.01	3.19	2.17	0.59	0.20	2.68
DN20c	3.50	4.65	3.19	0.98	0.24	3.94

### 30° inclined inlet/angle with connector

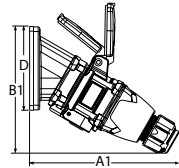

PRODUCT	A1	B1	D
DN9c	8.03	7.01	4.21
DN20c	12.72	10.04	5.51

### 30° inlet/angle

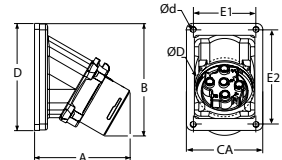

PRODUCT	A	B	CA	D	E1	E2	Ød	ØD
DN9c	3.86	4.65	2.99	4.21	2.48	3.74	0.22	2.36
DN20c	6.57	6.54	5.51	5.51	4.88	4.88	0.28	4.72

### 30° inclined inlet/angle/ junction box with connector

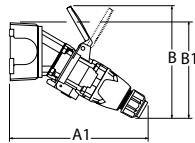

PRODUCT	A1	B	B1
DN9c	10.51	8.23	7.13
DN20	16.34	11.22	10.04

### inlet/angle/ metal junction box

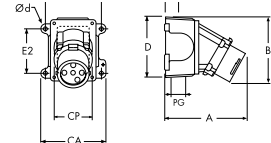

PRODUCT	A	B	CA	CP	D	E1	E2	H	PG	Ød
DN9c	6.34	4.40	4.25	3.03	4.57	3.75	2.78	1.18	1.00	0.25
DN20c	10.20	7.54	7.44	4.33	5.65	6.62	4.24	1.93	2.00	0.31

# Dimensions

## Receptacle – Provided in inches

Dimensions are for reference only and may change depending on accessories used. For precise dimensions contact MELTRIC Engineering.

### connector

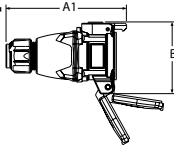

PRODUCT	A1	B
DN9c	6.65	3.86
DN20c	11.22	5.31

### receptacle with plug

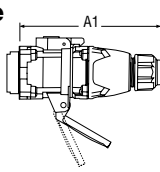

PRODUCT	A1
DN9c	6.85
DN20c	12.24

### receptacle

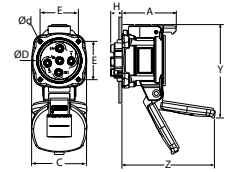

PRODUCT	A	C	E	H	Y	Z	Ød	ØD
DN9c	2.87	3.19	2.17	0.59	3.86	4.92	0.20	2.68
DN20c	4.33	4.65	3.19	0.94	5.20	7.68	0.24	3.94

### 30° inclined receptacle/angle with plug

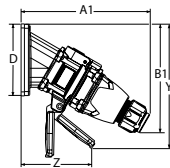

PRODUCT	A1	B1	D	Y	Z
DN9c	4.09	7.01	4.21	8.03	4.13
DN20c	13.78	10.43	5.51	10.75	7.17

### 30° receptacle/angle

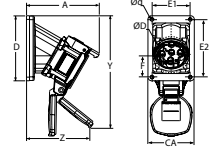

PRODUCT	A	CA	D	E1	E2	F	Y	Z	Ød	ØD
DN9c	5.00	2.99	4.21	2.48	3.74	1.57	8.03	4.13	0.22	2.36
DN20c	7.68	5.51	5.51	4.88	4.88	2.42	10.75	7.17	0.28	4.72

### 30° inclined receptacle/angle/junction box with plug

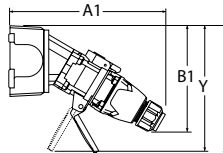

PRODUCT	A1	B1	Y
DN9c	6.57	7.13	8.15
DN20c	16.34	10.04	10.75

### receptacle/angle/metal junction box

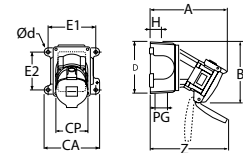

PRODUCT	A	B	CA	CP	D	E1	E2	H	PG	Y	Z	Ød
DN9c	7.48	6.89	4.40	2.91	4.57	4.19	2.78	1.18	1.00	8.15	6.61	0.25
DN20c	11.31	9.33	7.54	4.41	5.65	6.62	4.24	1.93	2.00	10.75	10.79	0.31